

Fossor

Multi-Role Vessel



TECHNICAL SPECIFICATION

General

Type of Vessel:	Twin Screw Multi-Role Vessel
Built	2009
Classification	MCA Workboat Cat 2/60

Dimensions

Length:	17.0m
Beam:	5.50m
Draft:	1.10m

Performance

Free Running Speed:	9 knots
Bollard Pull:	5 tonnes
Deck Carrying Capacity:	10 tonnes sq.m

Propulsion

Main Engines:	Cummins NT855
Total Power:	670HP @ 2100rpm
Gearbox:	MG-5112V twin disc 1:80
Bowthruster:	50hp hydraulic

Deck Equipment

Hydraulic Crane:	Hiab 102-4 3700kg @ 2.8m 730kg @ 11m.
Deck Winch:	10t pull
Hydraulic Spud Legs:	12m Hydraulic

Fossor is able to totally dry out on triple keels below prop level still providing 240 Volt power and operation of all hydraulics including the crane from air cooled power pack.

Auxiliary Equipment

Generators :	65HP
Bilge/GS Pumps (x2):	2 x 2000GPH pumps
Electrical system:	240V / 24V

Tank Capacities

Fuel Oil:	10,000 litres
Fresh Water:	10,000 litres

Accommodation

Comfortable, well equipped welfare facilities include galley, bunks, toilet wet room / drying room for 24 hour operations for 4 persons. Large stores area below decks.

Navigational Equipment

Chart Plotter:	Koden
Echosounder:	Furuno
Compass:	JRC GPS Compass
Radar:	Koden MDC 2560
DGPS:	Furuno GP36
VHF:	Icom DS100
Handheld VHF:	2 x Icom IC-M1
AIS:	JRC Class A
NAVTEX:	NX300

www.carmettugs.co.uk

Riverbank Road, Bromborough, Wirral, CH62 3JQ

phone: +44 (0) 1856 874725

email: tugs@carmet.co.uk

Fossor

Multi-Role Vessel



Additional Options

- 5m x 1.2m x 1.8m Plough
- SWP deployment platform

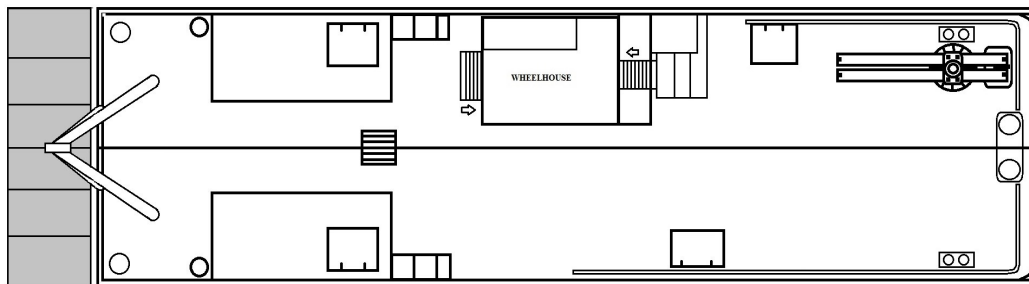
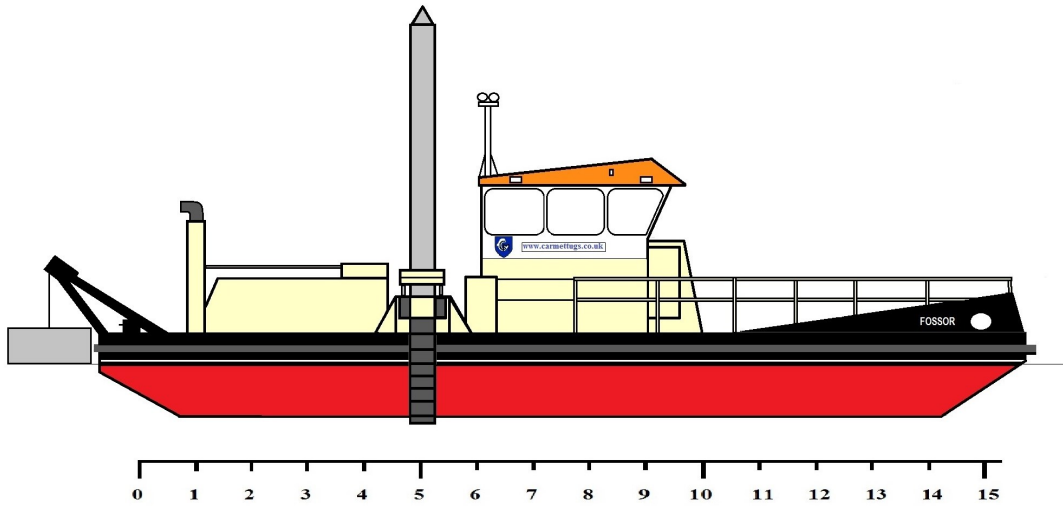

DECK LEVEL

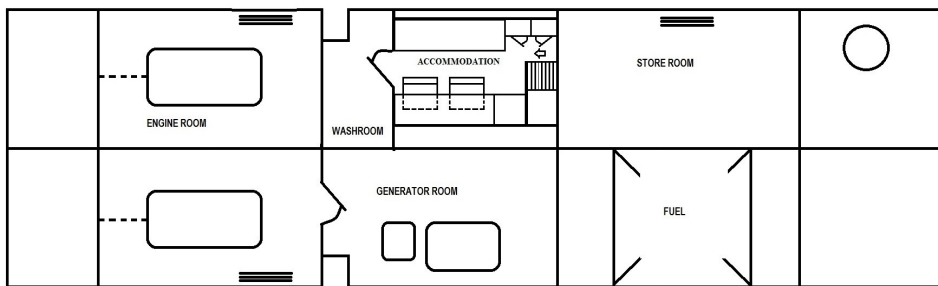

BELOW DECK

www.carmettugs.co.uk

Riverbank Road, Bromborough, Wirral, CH62 3JQ

phone: +44 (0) 1856 874725

email: tugs@carmet.co.uk