

# M.S.C. Viceroy

Harbour Tug



## TECHNICAL SPECIFICATION

### General

**Type of Vessel:** Twin Screw Tug  
**Built:** James W. Cook & Co Ltd, 1974

### Dimensions

**Length:** 28.63m  
**Beam:** 7.78m  
**Draft:** 3.64m  
**gt:** 137

### Performance

**Free Running Speed:** 12 knots  
**Bollard Pull:** 16 tonnes

### Propulsion

**Main Engines:** 2 x WH Allen 8PBS12-D  
**Total Power:** 1280HP @ 600rpm  
**Gearboxes:** MWD PRV405 reverse reduction  
**Propulsion:** 2 x 2310mm 4 blade fixed pitch props

### Auxiliary Equipment

**Generators (x2):** Gardner GLX 80HP @ 100rpm  
**Bilge/GS Pumps (x2):** 35tph @ 4-PSI  
**Fuel Transfer Pumps:** 1682l/h  
**Electrical system:** 24 V DC / 220V shore connection

### Deck Equipment

**Towing Hook:** 20tonnes SWL  
**Bow Fender:** Bow pusher  
**Fendering:** Firestone all round

### Tank Capacities

**Fuel Oil:** 33 m<sup>3</sup>  
**Fresh Water:** 7.2 m<sup>3</sup>

### Accommodation

Large wheelhouse with bench seating. 2 x 1 person cabins deck level, on with sink. 2 x 1 person cabins below deck. Crew mess below deck. Galley, WC, shower and washing machine.

### Navigational Equipment

**Echosounder:** Furuno FCV  
**VHF:** Compact SX25  
Icom M501EURO  
Icom IC-M1  
**Handheld VHF:** Francis  
**Searchlight:** Francis  
**AIS:** Simrad A150

[www.carmettugs.co.uk](http://www.carmettugs.co.uk)

Riverbank Road, Bromborough, Wirral, CH62 3JQ

phone: +44 (0) 1856 874725

email: [tugs@carmet.co.uk](mailto:tugs@carmet.co.uk)

# M.S.C. Viceroy

Harbour Tug

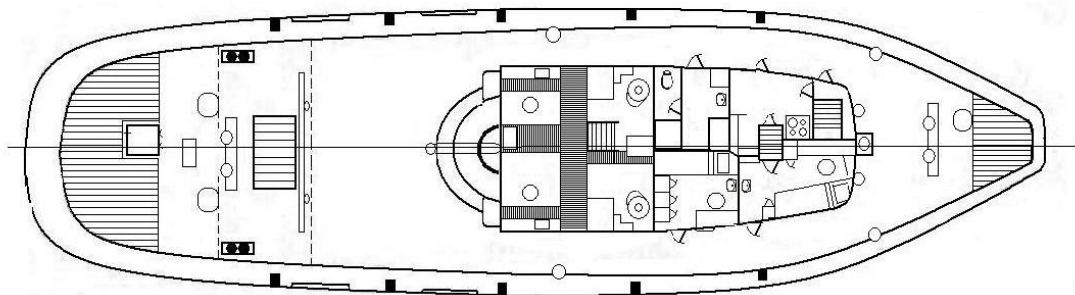
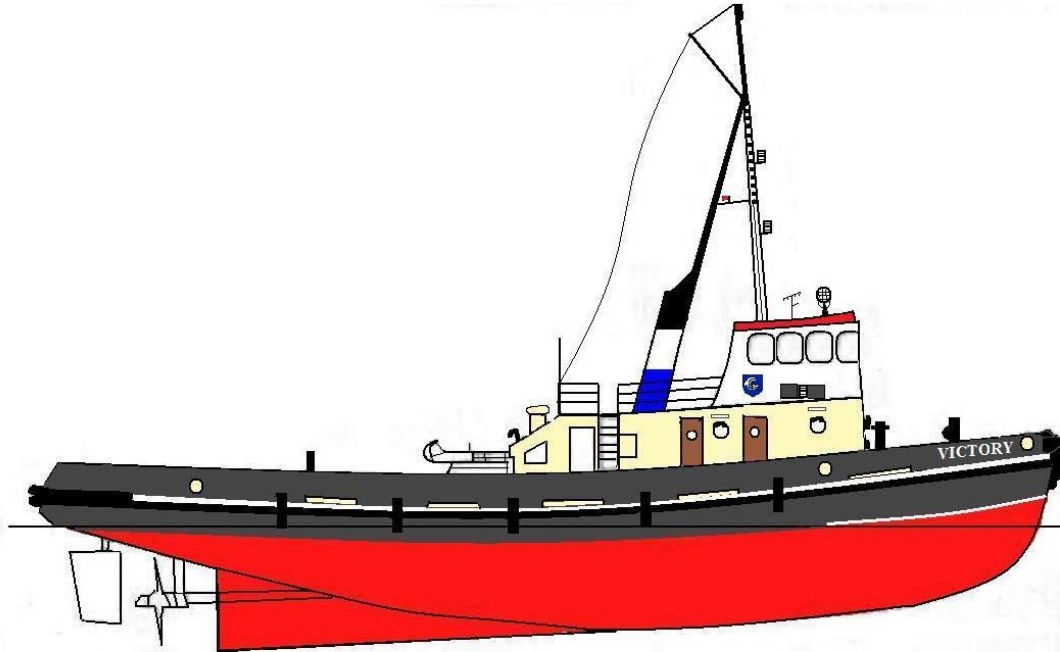

Main Deck

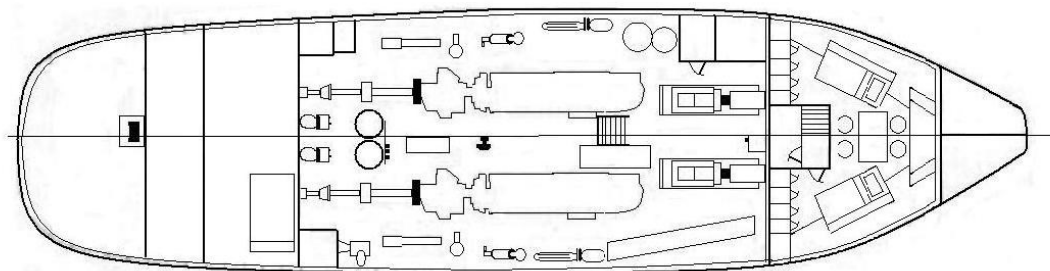

Below Deck

Scale

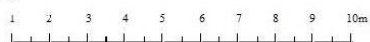

[www.carmettugs.co.uk](http://www.carmettugs.co.uk)

Riverbank Road, Bromborough, Wirral, CH62 3JQ

phone: +44 (0) 1856 874725

email: [tugs@carmet.co.uk](mailto:tugs@carmet.co.uk)