

M.S.C. Viceroy

Harbour Tug



TECHNICAL SPECIFICATION

General

Type of Vessel: Twin Screw Tug
Built: James W. Cook & Co Ltd, 1974

Dimensions

Length: 28.63m
Beam: 7.78m
Draft: 3.64m
gt: 137

Performance

Free Running Speed: 12 knots
Bollard Pull: 16 tonnes

Propulsion

Main Engines: 2 x WH Allen 8PBS12-D
Total Power: 1280HP @ 600rpm
Gearboxes: MWD PRV405 reverse reduction
Propulsion: 2 x 2310mm 4 blade fixed pitch props

Auxiliary Equipment

Generators (x2): Gardner GLX 80HP @ 100rpm
Bilge/GS Pumps (x2): 35tph @ 4-PSI
Fuel Transfer Pumps: 1682l/h
Electrical system: 24 V DC / 220V shore connection

Deck Equipment

Towing Hook: 20tonnes SWL
Bow Fender: Bow pusher
Fendering: Firestone all round

Tank Capacities

Fuel Oil: 33 m³
Fresh Water: 7.2 m³

Accommodation

Large wheelhouse with bench seating. 2 x 1 person cabins deck level, on with sink. 2 x 1 person cabins below deck. Crew mess below deck. Galley, WC, shower and washing machine.

Navigational Equipment

Echosounder: Furuno FCV
VHF: Compact SX25
Icom M501EURO
Handheld VHF: Icom IC-M1
Searchlight: Francis
AIS: Simrad A150

www.carmettugs.co.uk

Riverbank Road, Bromborough, Wirral, CH62 3JQ

phone: +44 (0) 1856 874725

email: tugs@carmet.co.uk

M.S.C. Viceroy

Harbour Tug

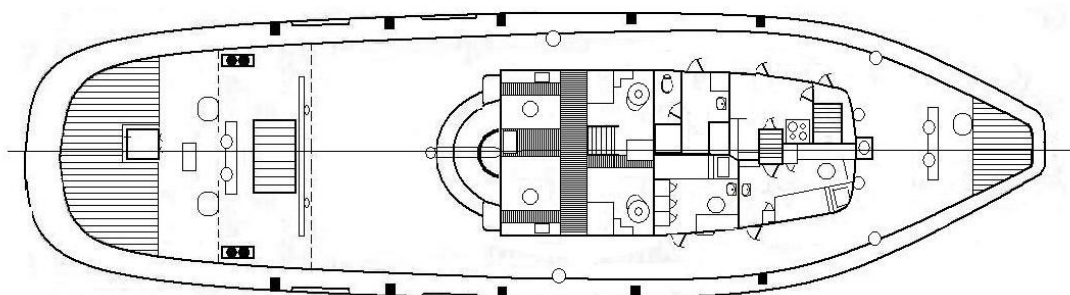
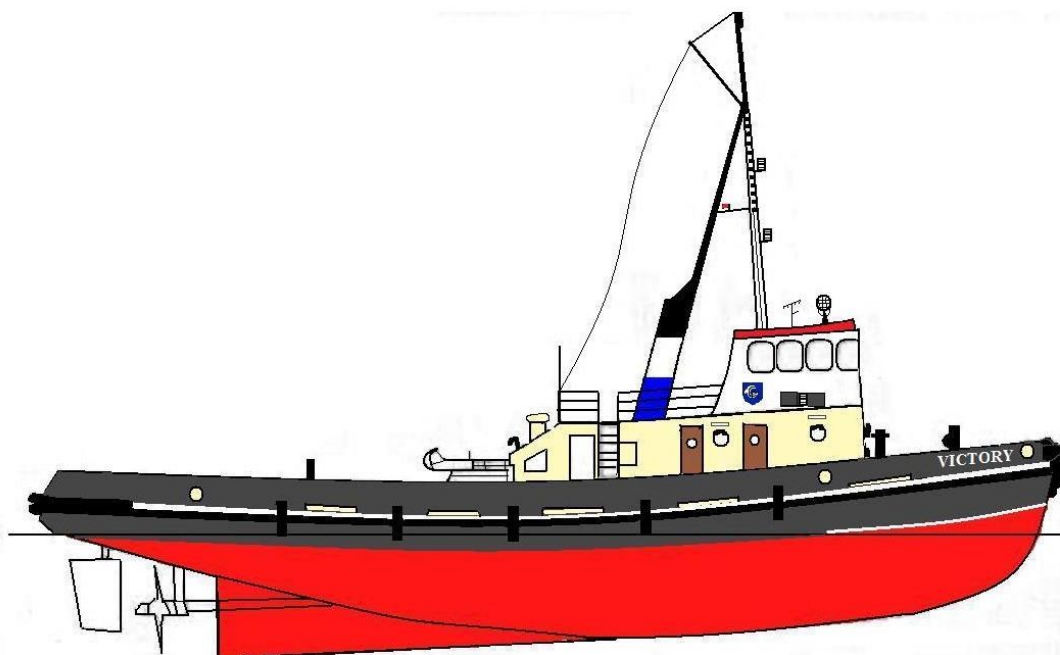

Main Deck

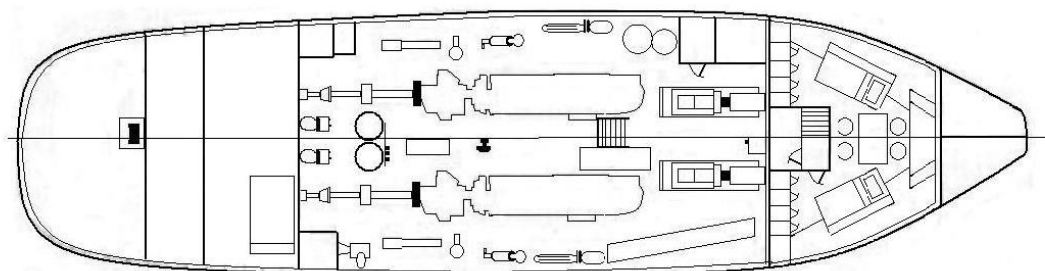

Below Deck

Scale

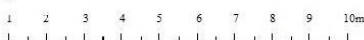

www.carmettugs.co.uk

Riverbank Road, Bromborough, Wirral, CH62 3JQ

phone: +44 (0) 1856 874725

email: tugs@carmet.co.uk