



TECHNICAL SPECIFICATION

General

Type of Vessel:	Multi-Role Vessel
Built:	McTay Marine Services, 2013
Certification:	MCA Workboat Code Cat 2/60

Dimensions

Length:	17.00m
Beam:	7.00m
Draft Light:	1.2m
Draft Loaded:	1.8m
Displacement:	90 tonnes

Performance

Free Running Speed:	8.50 knots
Bollard Pull:	6.50 tonnes
Deck Carrying Capacity:	7.5 tonnes sq.m

Propulsion

Main Engines:	2 x Doosan MD 196 T1
Total Power:	640BHP @ 2000rpm
Gearboxes:	Dong 3.46 : 1
Propulsion:	2 x Shrouded 5 blade fixed pitch props

Tank Capacities

Fuel Bunkers:	2 x 6200 litres
Fresh Water:	1000 litres

Auxiliary Equipment

Generator No 1:	Cummins 6BT 5.9 DM 34kVA
Generator No 2:	Beta Marine BV 3000 G3 46kVA
Fuel Transfer Pumps:	100lpm
Electrical system:	415 V, with a 220 V Shore con

Deck Equipment

Hydraulic Crane:	Atlas A620.3 A6 62 t/m
Deck Winch:	Nippon Pusnes 10 tonne
Deck Protection:	Timber

Accommodation

Wheelhouse with a bench seat. Galley / day room with sanitary space.
Below deck 2 x 2 person cabins and Large workshop / store room.

Navigational Equipment

Radar/chart plotter:	Furuno NavNet 3D MFD12
Radar:	Furuno DR5 4D
NavPilot:	Furuno FAP 7001
GPS:	Furuno GP37
Echosounder:	Furuno LS-6100
VHF:	2 x Icom IC-M423
Handheld VHF:	Icom IC-M23
Compass:	Ritche
Searchlight:	Stryler 3049R

Vital

Multi-Role Vessel

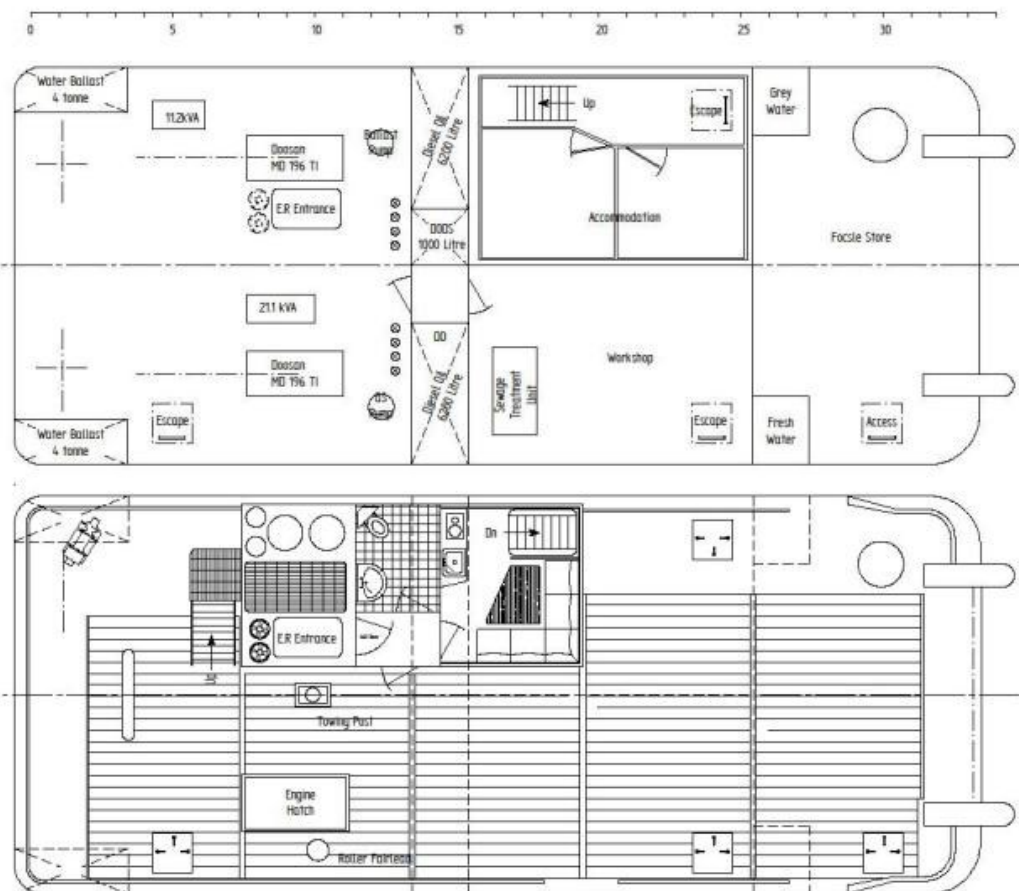
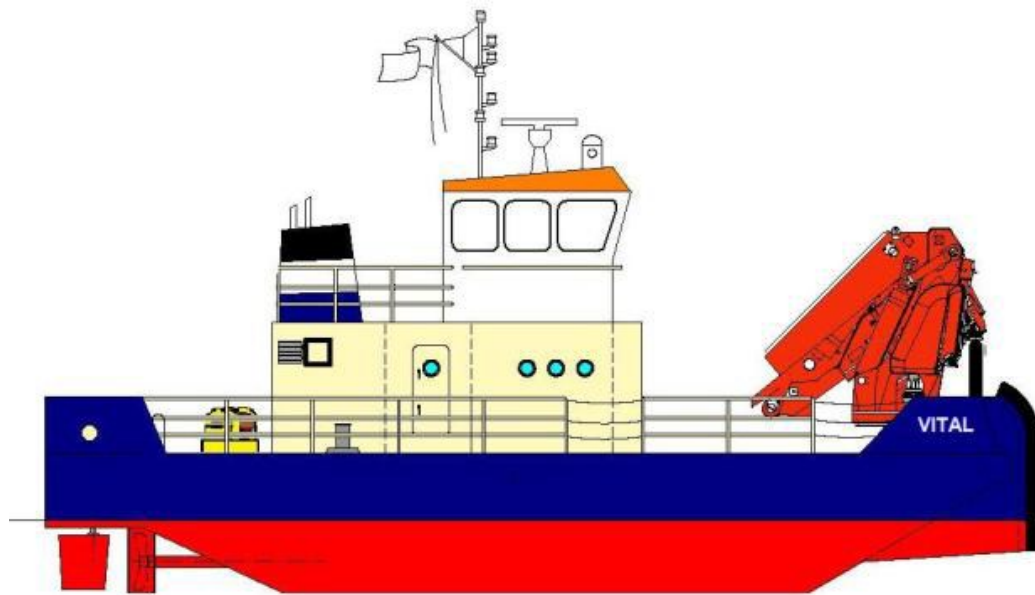

www.carmettugs.co.uk

Riverbank Road, Bromborough, Wirral, CH62 3JQ

phone: +44 (0) 151 327 8018

email: tugs@carmet.co.uk