

Fossor

Multi-role Vessel



Type of Vessel:	Multi-Role Vessel
Built:	1991, Rebuilt 2009
Classification:	MCA Fit for Purpose
Length:	17.00 m
Beam:	4.90 m
Draft:	1.10 m
Free Running Speed:	8.0 knots
Bollard Pull:	5.0 tonnes
Deck Carrying Capacity:	10 tonnes
Main Engines:	Baudouin 6 M16 (2018)
Total Power:	710 bhp @ 2100rpm
Gearbox:	MG-5112V twin disc 1:80
Bowthruster:	50hp hydraulic
Generator Sets:	1 x Kubota 65kw, 1 x Perkins 65kw
Electrical system:	240v / 24v
Fuel Bunkers:	8,000 litres
Fresh Water:	1000 litres
Deck Crane:	Hiab 102-4, 3700kg @ 2.8m, 730kg @ 11m.
Deck Winch:	10t pull
Hydraulic Spud Legs:	12m Hydraulic
Additional:	A-frame & plough
Accommodation:	Comfortable, well equipped welfare facilities include galley, bunks, toilet wet room / drying room for 24 hour operations for 4 persons. Large stores area below decks.
Navigation Equipment:	Chart Plotter: Koden, Echosounder: Furuno, Compass: JRC GPS Compass, Radar: Koden MDC 2560, DGPS: Furuno GP36, VHF: Icom DS100, Handheld VHF: 2 x Icom IC-M1, AIS: JRC Class A, NAVTEX: NX300

Fossor

Multi-role Vessel

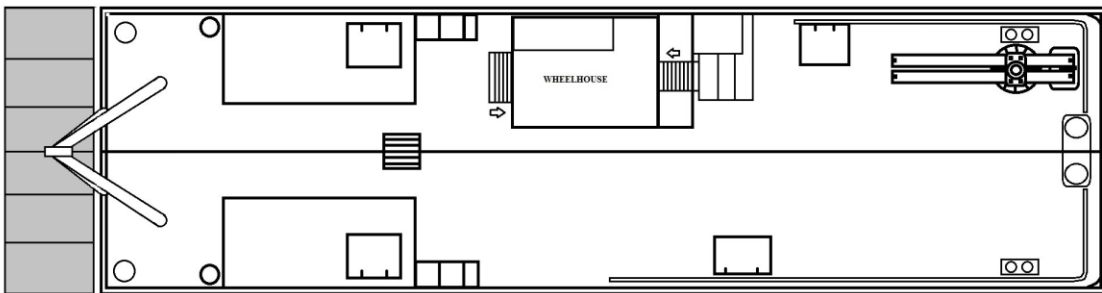
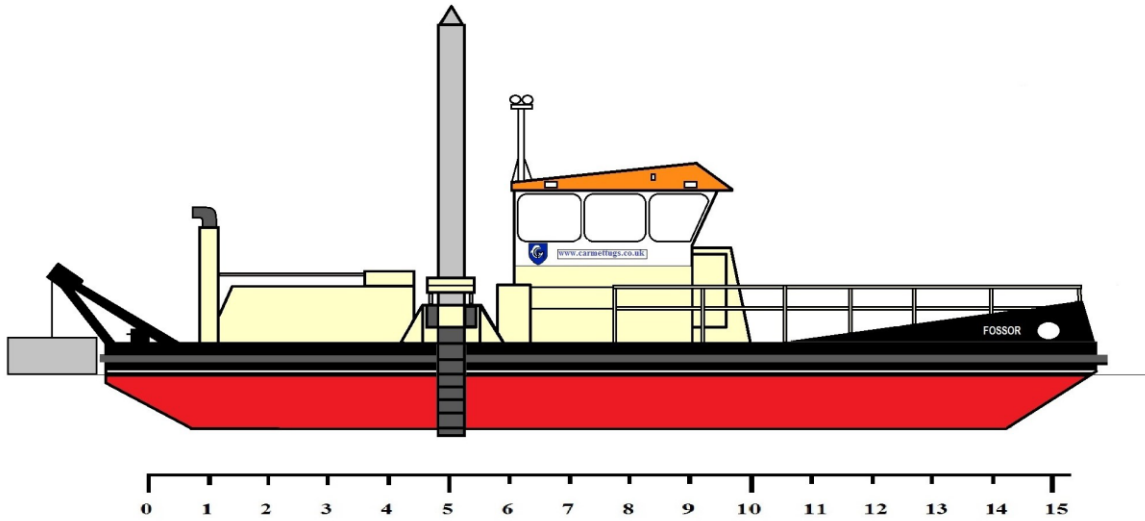

DECK LEVEL

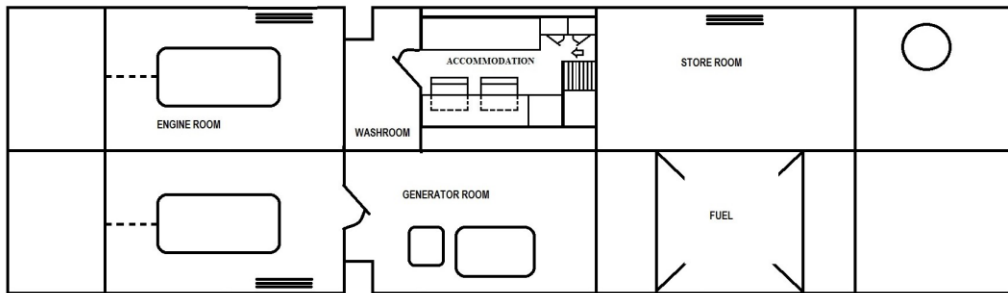

BELOW DECK